



**SUNA**

**Distrito  
del Sol**









# SPACES THAT INSPIRE **BELONGING**

This environment is defined by **its warm climate, natural wealth, and captivating landscapes.**

Making it an ideal destination for those seeking a closer connection with nature and the tranquility of a serene atmosphere.









SUNA is a **residential apartment project** located within the development corridor of western Antioquia, encompassing Santa Fe de Antioquia and Sopetrán.

It is part of our large-scale master plan, Distrito del Sol, an integrated urban development strategy in an area of significant appreciation. The project also offers short-term rental possibilities, making it suitable for both residential and tourist use.

SUNA is composed of **four phases**, each consisting of **three-level towers** with **24 apartments per tower—eight per floor—**surrounded by a natural, countryside setting.





# 62 M<sup>2</sup> APARTMENTS GROSS BUILT AREA











# URBAN DESIGN / AMENITIES

- Swimming Pool
- Walking Trail
- Padel Court
- Parking Spaces
- Social Lounge / BBQ
- Children's Playground
- Outdoor Gym

The illustrations presented here include aesthetic elements that are architectural and design interpretations, and therefore do not constitute a binding commitment from the developer. Designs and amenities are subject to change. Apartments are delivered in shell condition (unfinished interiors).



# TYPICAL FLOOR PLAN

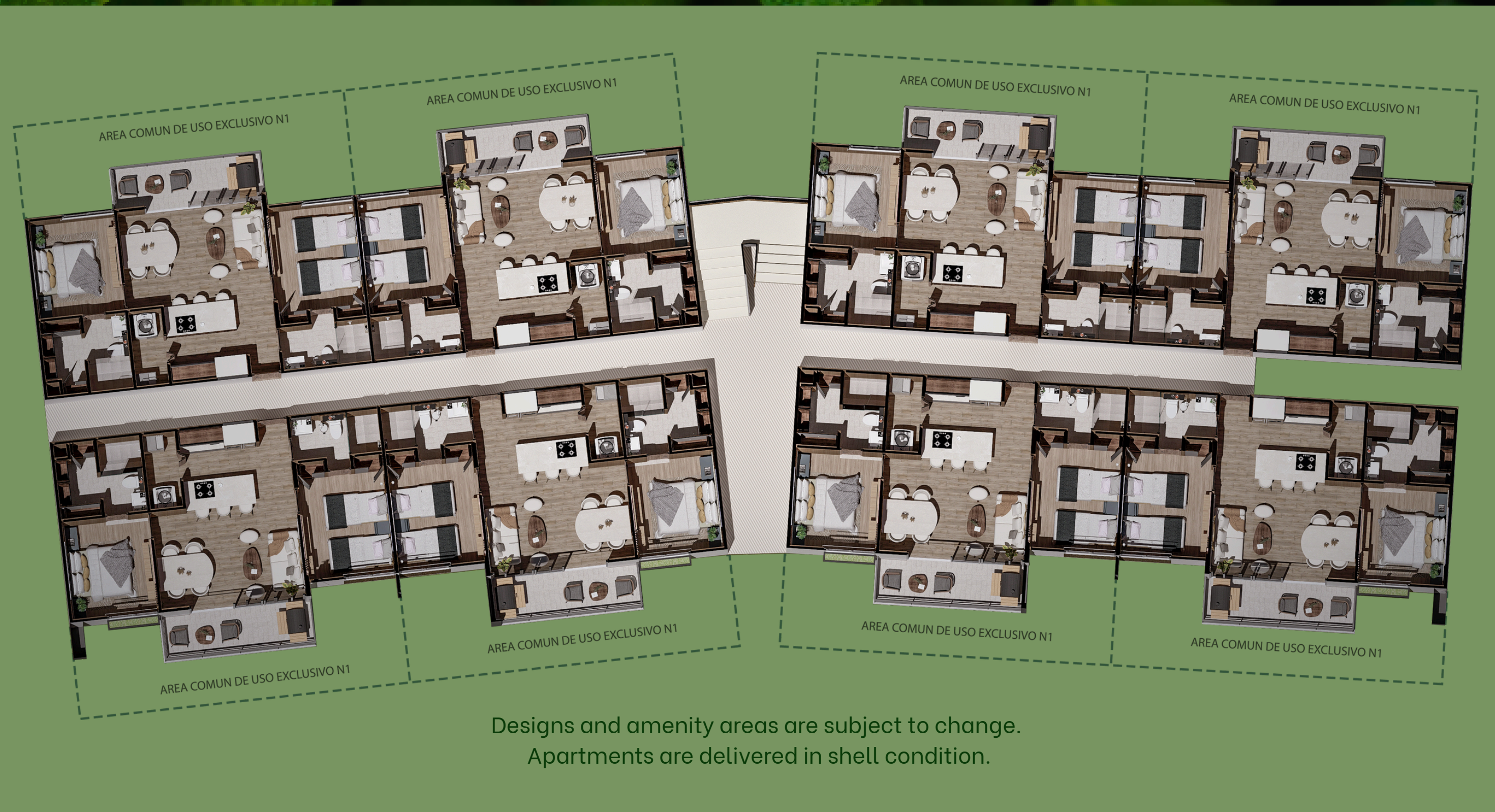



# TYPICAL FLOOR PLAN A, D, E, H



**GROSS BUILT AREA : 62.30M<sup>2</sup>**

**NET USABLE AREA: 57.70M<sup>2</sup>**

The illustrations presented here include aesthetic elements that represent the architect's and designer's interpretations, and therefore do not constitute a binding commitment from the developer. Designs and amenity areas are subject to change. Apartments are delivered in shell condition.

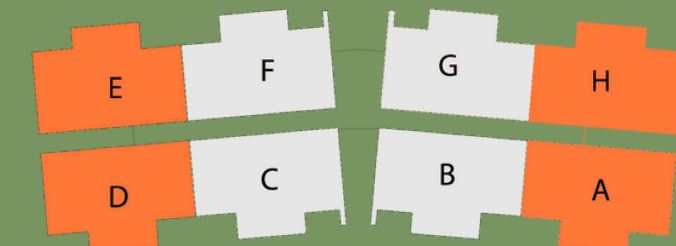



# TYPICAL FLOOR PLAN B, C



**GROSS BUILT AREA : 62.00M<sup>2</sup>**

**NET USABLE AREA: 57.70M<sup>2</sup>**

The illustrations presented here include aesthetic elements that represent the architect's and designer's interpretations, and therefore do not constitute a binding commitment from the developer. Designs and amenity areas are subject to change. Apartments are delivered in shell condition.

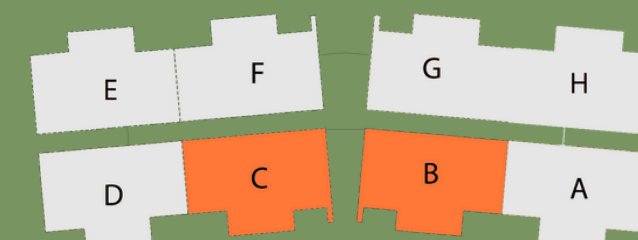



# TYPICAL FLOOR PLAN F, G



**GROSS BUILT AREA : 61.80M<sup>2</sup>**

**NET USABLE AREA: 57.70M<sup>2</sup>**

The illustrations presented here include aesthetic elements that represent the architect's and designer's interpretations, and therefore do not constitute a binding commitment from the developer. Designs and amenity areas are subject to change. Apartments are delivered in shell condition.

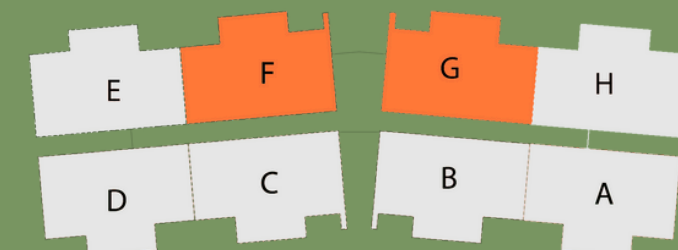



# CUSTOMER SERVICE LINES



**+57 324 477 82 94**



**+57 304 478 59 79**

CUSTOMER SERVICE LINES  
FOR **COLOMBIANS ABROAD**



**+57 300 824 33 25**

**WWW.INTERCASA.COM.CO**









# SUNA

Distrito  
del Sol